

---

# 18/14mm Ribbed Duct Orange 2000m

**Product Images**

**Product Code: 62751/2KM**

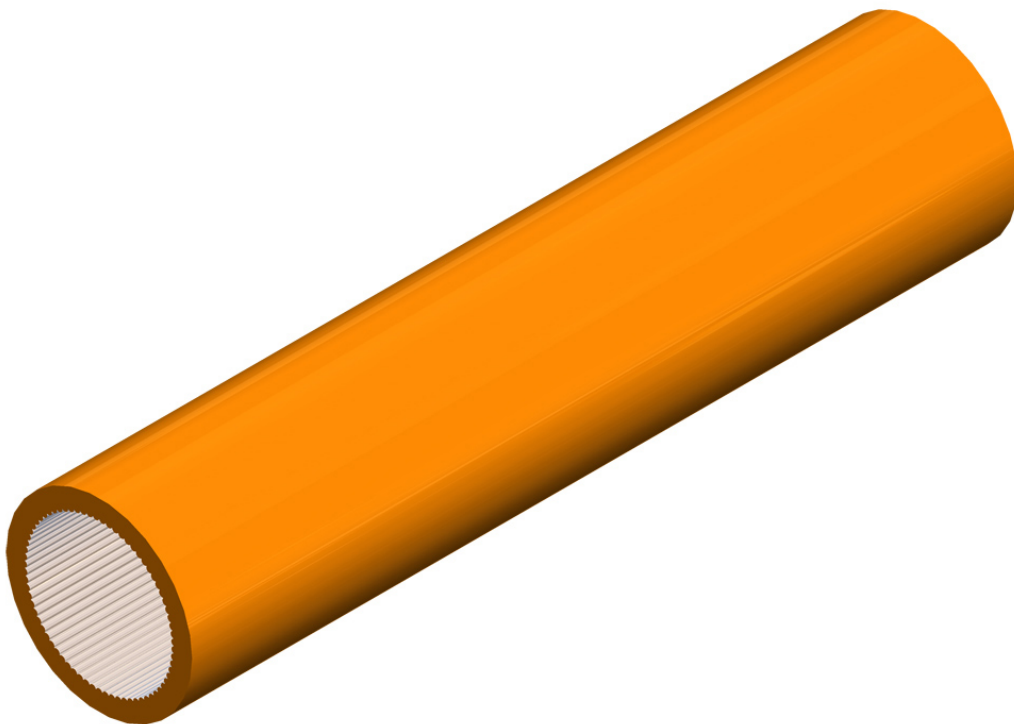

## Short Description

---

HDPE ribbed duct designed as a cable pathway for use in telecom networks.

### Overview

Product Diameter 18mm

Product Weight 95.8g/m

Metal Free Yes

Minimum Bend Radius (Note 4) 10D

Maximum Tensile Load 1500N

Product Specification MHT582

Duct Type 18/14mm, HDPE, low friction liner, ribbed orange

Print Marking Metre Mark Emtelle Fibreflow, Date & Time Laser Pictogram

Product Length 2000 metres (2 kilometres)

Pack Type B drum wood 1200 x 500 x 900mm

Note 1: Diameters and thicknesses are measured to nearest 0.1mm.

Note 2: All dimensions and weight are 'nominal'.

Note 3: 'nominal' data is based on middle-spec, and is for information only, not for inspection purposes.

Note 4: 'D' is the appropriate product diameter for the bending direction.

**Please see datasheet for full details.**

**Additional carriage charges may apply. Please contact sales for further information**

## Description

---

HDPE ribbed duct designed as a cable pathway for use in telecom networks.

### Overview

Product Diameter 18mm

Product Weight 95.8g/m

Metal Free Yes

Minimum Bend Radius (Note 4) 10D

Maximum Tensile Load 1500N

Product Specification MHT582

Duct Type 18/14mm, HDPE, low friction liner, ribbed orange

Print Marking - Metre Mark Emtelle Fibreflow, Date & Time Laser Pictogram

Product Length 2000 metres (2 kilometres)

Pack Type B drum wood 1200 x 500 x 900mm

Note 1: Diameters and thicknesses are measured to nearest 0.1mm.

Note 2: All dimensions and weight are 'nominal'.

Note 3: 'nominal' data is based on middle-spec, and is for information only, not for

inspection purposes.

Note 4: 'D' is the appropriate product diameter for the bending direction.

**Please see datasheet for full details.**

**Additional carriage charges may apply. Please contact sales for further information**