

AX-S™ Concrete Infill

Frame & Cover B125

600mm x 450mm



Product Description

AX-S™ Concrete Infill covers can be manufactured to suit an extensive range of clear openings, an industry favourite for their simplicity and ease of use.

Frame Details

Clear Opening:	600mm x 445mm	Including Riser:	N/A
External Dimensions:	692mm x 537mm	Crosspiece(s):	N/A
Depth:	52mm	Weight:	5.3kg

Cover Details

Cover Type 1:	1 x 682mm x 528mm
Weight:	43kg

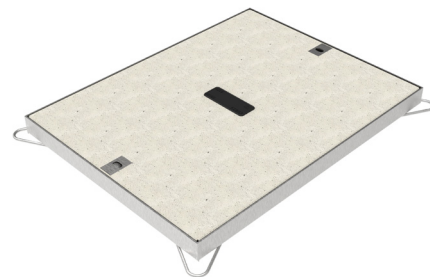

Overall Details

Product Code:	FCCIMP-06000450-00*0*B**1
Total Weight:	48kg

Installation

The product is designed for use in both footway and roadway installations where it provides access to underground ducting (EN124 Class A15-B125).

Key Features

- Easy slide out covers
- No inherent scrap value
- Anti-slip surface



Scan for access to technical documents library

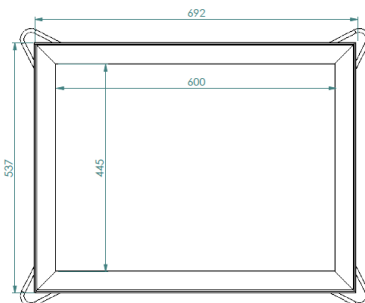

Concrete Infill cross-section top view

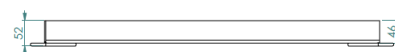

Concrete Infill cross-section detail

FCCI-600x450-B V.02 20/02/2020